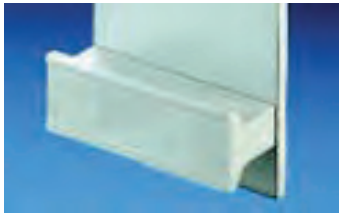
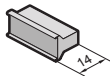

Front panels, handles

**Type V handle****Plastic****Material:**
Plastic

HP	Colour	Packs of	Model No. RP
3	Grey	1	3685.490
4	Grey	1	3685.491
8	Grey	1	3685.492
12	Grey	1	3685.493
20	Grey	1	3685.494
3	Black	1	3685.495
4	Black	1	3685.496
8	Black	1	3685.497
12	Black	1	3685.498
20	Black	1	3685.499

**Also required:**Mounting kit,
packs of 1 set, Model No. RP 3687.519**Identification strips
for type V handle, plastic
self-adhesive**

HP	Packs of	Model No. RP
24	1	3687.693

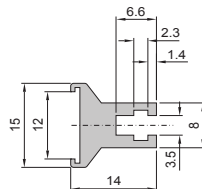
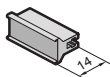
**Type V handle****Aluminium****Material:**
Aluminium, anodised.

HP	Model No. RP	HP	Model No. RP
3	3685.595	12	3685.602
4	3685.596	14	3685.603
5	3685.597	21	3685.761
6	3685.598	28	3685.762
7	3685.599	42	3685.763
8	3685.600	1 m	3685.604
10	3685.601		



Custom lengths available.

**Also required:**Mounting kit
packs of 1 set, Model No. RP 3687.146
(from 6 HP 2 packs required)**Identification strips
for type V handle, aluminium**

For individual labelling of the handles.

Material:
0.5 mm Aluminium, anodised

HP	Packs of	Model No. RP
3	1	3685.746
4	1	3685.747
5	1	3685.748
6	1	3685.749
7	1	3685.750
8	1	3685.751
10	1	3685.752
12	1	3685.753
14	1	3685.754
21	1	3685.755
28	1	3685.756
42	1	3685.757
1 m	1	3685.758
0.5 m	5	3606.300



Custom lengths available.

Front panels, handles

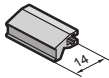

Type VI handle

Aluminium

Material:
Aluminium, anodised

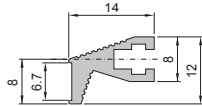

HP	Model No. RP	HP	Model No. RP
3	3685.605	12	3685.612
4	3685.606	14	3685.613
5	3685.607	21	3685.614
6	3685.608	28	3685.615
7	3685.609	42	3685.616
8	3685.610	84	3685.617
10	3685.611	1 m	3685.618

Custom lengths available.



Also required:

Mounting kit
packs of 1 set, Model No. RP 3687.146
(from 6 HP 2 packs required)



PCB holder kit

For attaching the PCB to front panels with handle types I, II, IV, IVs, VII.

Material:
Die-cast

Note:
Only required at the top with 3U front panels.

Packs of	Model No. RP
10	3685.198



Also required:

For securing PCBs to PCB holders:
Pan-head screws
packs of 100, Model No. RP 3654.320
For attaching the front panel to the PCB holder:
Oval head screw
packs of 100, Model No. RP 3685.282.



PCB holder

For front panels
For attaching PCBs to front panels (handle type V, VI).

Material:
Noryl

Supply includes:
Assembly parts.

Packs of	Model No. RP
10	3606.330

