

## Injector/extractor handles

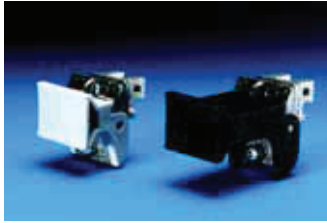

### Extractor handle type I and type II

Suitable for flat front panels/U-channel front panels  
With removal function  
May be used in combination with horizontal rails with 10 mm extension.

Supply includes:  
Assembly parts.

Note:  
With 3 U, only one extractor handle is required.

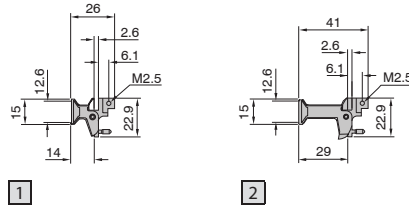
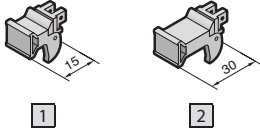

#### 1 Type I extractor handle, 15 mm

Colour	Packs of	Model No. RP
Grey	1	3685.587
Black	1	3685.589

#### 2 Type II extractor handle, 30 mm

Colour	Packs of	Model No. RP
Grey	1	3685.588
Black	1	3685.590

#### + Accessories:

Identification strips for extractor handles, see page 595.



### Injector/extractor handle type IV

#### Handles with micro-switch

For inserting and removing connectors with a large number of pins.

- Insertion/removal function
- Integral microswitch for "live insertion" applications
- Self-activation of the micro-switch during insertion/removal
- ESD pin to dissipate static charges before contacting the connectors and for precise positioning of the board type plug-in unit
- Codeable
- Integral PCB attachment
- Self-locking
- Bayable.

#### Handle without micro-switch

Description see above. Micro-switch, may be retrofitted.

Supply includes:  
1 handle without or with micro-switch, assembly parts.

#### Note:

- Insertion only when used with front horizontal rails, with 10 mm extension (B, B1, B2), see page 155, 156.
- With 3U front panels, only one extractor handle is required.

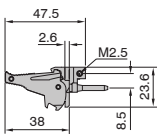
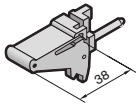

#### Handles with micro-switch

Colour	Installation	Packs of	Model No. RP
Grey	top	1	3686.905
Grey	bottom	1	3686.904
Black	top	1	3686.907
Black	bottom	1	3686.906

#### Handle without micro-switch

Colour	Installation	Packs of	Model No. RP
Grey	top	1	3686.901
Grey	bottom	1	3686.900
Black	top	1	3686.903
Black	bottom	1	3686.902

#### + Accessories:

Keys  
Keyable guide rails  
Micro-switches  
Connector pin for baying



### Injector/extractor handle type IV

#### 8 HP, bayed

Suitable for 4 HP front panels that must be connected to each other mechanically.

Supply includes:  
2 bayed handles, fully assembled.

Colour	Installation	Packs of	Model No. RP
Black	bottom	1	3686.908
Black	top	1	3686.909

#### + Accessories:

Connector pin for baying,

## Front panels, handles

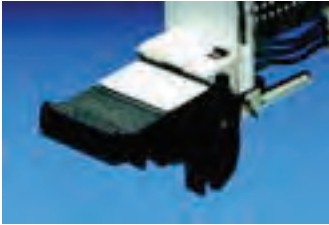
**Identification strips**

for type I, II extractor handle and type IV injector/extractor handle  
Width 4 HP

Packs of	Model No. RP
100	3684.328

**Injector/extractor handle type IVs****with push-button**

For inserting and removing connectors with a large number of pins. A metal insert ensures reliable functioning, even at forces of up to 815 N.

- Insertion/removal function
- Push-button for locking and unlocking the board type plug-in unit (cannot be extracted in the locked position)
- Optionally with 1/2 HP offset PCB attachment, e.g. for component mounting on both sides
- Optional integral micro-switch for "live insertion" applications
- ESD pin to dissipate static charges before contacting the connectors and for precise positioning of the board type plug-in unit
- Codeable
- Integral PCB attachment
- Bayable.

**Material:**

Plastic/metal

**Supply includes:**

Assembly parts.

**Note:**

- Insertion only when used with front horizontal rails, with 10 mm extension (B),
- With 3 U front panels, only one extractor handle is required.

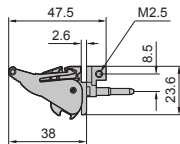
**Handles without offset**

Installation	Packs of	Model No. RP
top	1	3688.770
bottom	1	3688.771

**Handles with 1/2 HP offset**

Installation	Packs of	Model No. RP
top	1	3688.772
bottom	1	3688.773

+	<b>Accessories:</b>
---	---------------------

Keys,

Keyable guide rails

Keyable guide rails with 1/2 HP offset

Micro-switches

Connector pin for baying

**Connection pin**

for injector/extractor handles, types IV, IVs and VII

The connection pin can be used to connect injector/extractor handles, types IV, IVs and VII.

**Material:**

Steel

Packs of	Model No. RP
20	3685.319

## Injector/extractor handles

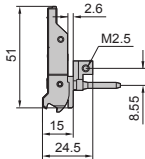

### Injector/extractor handle type VII

#### Plastic (telecom)

For inserting and removing connectors with a large number of pins. This handle was specifically designed for use in telecom applications.

- Insertion/removal function
- Optionally with 1/2 HP offset PCB attachment, e.g. for component mounting on both sides
- Minimum front space requirements, due to fold-up handle
- Codeable
- Optional integral micro-switch for "live insertion" applications
- ESD pin to dissipate static charges prior to making contact with the connectors and for precise positioning of the board type plug-in unit
- Large labelling area on the front.

**Material:**  
Plastic

**Supply includes:**  
Assembly parts.

#### Note:

Insertion only when used with front horizontal rails, with 10 mm extension (B),

#### Handles without offset

Installation	Packs of	Model No. RP
top	1	3688.784
bottom	1	3688.785

#### Handles with 1/2 HP offset

Installation	Packs of	Model No. RP
top	1	3688.780
bottom	1	3688.781



#### Accessories:

Keys,

Keyable guide rails

Keyable guide rails with 1/2 HP offset

Micro-switches

Connector pin for buying

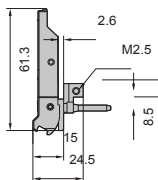

### Injector/extractor handle type VII

#### Metal (telecom)

For inserting and removing connectors with a large number of pins (up to 815 N). This handle was specifically designed for use in telecom applications.

- Insertion/removal function
- Optionally with 1/2 HP offset PCB attachment, e.g. for component mounting on both sides
- Minimum front space requirements, due to fold-up handle
- Codeable
- Optional integral micro-switch for "live insertion" applications
- ESD pin to dissipate static charges prior to making contact with the connectors and for precise positioning of the board type plug-in unit
- Metal design for use in aggressive atmospheres.

**Material:**  
Die-cast zinc

**Supply includes:**  
Assembly parts.

#### Note:

Insertion only when used with front horizontal rails, with 10 mm extension (B),

#### Handles without offset

Installation	Packs of	Model No. RP
top	1	3688.790
bottom	1	3688.791

#### Handles with 1/2 HP offset

Installation	Packs of	Model No. RP
top	1	3688.786
bottom	1	3688.787



#### Accessories:

Keys

Keyable guide rails

Keyable guide rails with 1/2 HP offset

Micro-switches

Connector pin for buying



### Micro-switch

For "live insertion" applications. Installation in injector/extractor handles, types IV, IVs and VII. May also be retrofitted.

#### Technical specifications:

Switching load: 50 mA 30 V DC  
Service life/switching cycles:  
At nominal load: 30,000  
mechanical: 50,000

Packs of	Model No. RP
10	3684.410



#### Also required:

Micro-switch mounting clip

## Front panels, handles



### Micro-switch

#### with cable and connector

For "live insertion" applications.  
Installation in injector/extractor handles, types IV, IVs and VII.

#### Supply includes:

Micro-switch, connector type Molex 51021-0300, mounting clips, 3 cables, 25 mm x #32 AWG, fully assembled.

- 1 Lever not depressed
- 2 Lever hinge
- 3 Lever contact point

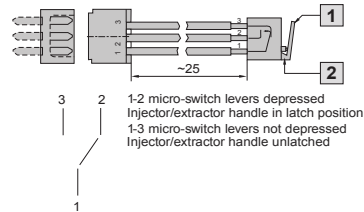

Packs of	Model No. RP
1 set	3686.536

**!** Also required:

Micro-switch mounting clip

Micro-switch:with cable and connector

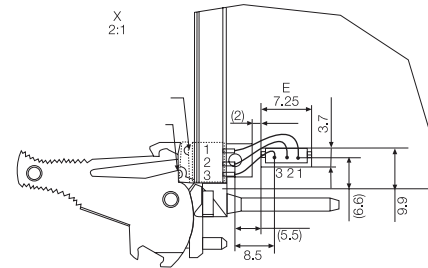

### Micro-switch mounting clip

For mounting micro-switches in handles.

Packs of	Model No. RP
10	3684.411



### Plastic covers

#### for PCBs

For mechanical protection of the component side and of the EMC gaskets.  
Attachment holes as per cPCI or VME-specifications. Optionally available as perforated or solid version.

#### Material:

0.3 mm plastic, anti-static  
Maximum temperature up to 65°C

<sup>1)</sup> 0.5 mm plastic, transparent, anti-static  
UL 94-V0, maximum temperature up to 65°C

<sup>2)</sup> 0.5 mm plastic, black, anti-static UL 94-V0,  
maximum temperature up to 120°C

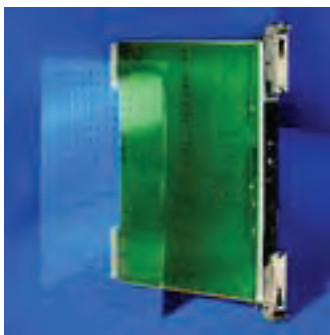

For PCBs	Packs of	Model No. RP			
		for cPCI		for VME	
		perforated <sup>1)</sup>	solid <sup>1)</sup>	solid	solid
3U x 160 mm	1	3687.932	3686.572	3685.966	3685.626
	5	—	—	—	3685.279
3U x 220 mm	1	—	—	—	3685.805
	5	—	—	—	3685.266
6U x 80 mm	1	3687.933	3686.573	3686.037	3686.146
6U x 160 mm	1	3687.934	3686.574	3685.967	3685.627
	1	9905.574 <sup>2)</sup>	9905.990 <sup>2)</sup>	—	—
	5	—	—	—	3685.280
6U x 220 mm	1	—	—	—	3685.824
	5	—	—	—	3685.000

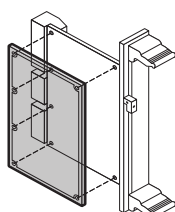

**!** Also required:

Required for mounting the perforated  
cPCI covers:

Mounting clips

Packs of	Model No. RP
100	3687.955

## Front panels, handles

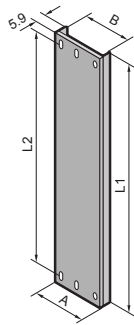

### Front panels for type III extractor handle

**Material:**  
1.0 mm extruded aluminium section

**Surface finish:**  
Untreated

HP	A mm	W (B) mm	C1 mm	C2 mm	Model No. RP		
					3U	6U	9U
3	15.20	12.20	-	-	<b>3685.548</b>	<b>3685.555</b>	-
4	20.22	17.20	-	-	<b>3685.549</b>	<b>3685.556</b>	<b>3685.562</b>
5	25.28	22.28	-	22.68	<b>3685.550</b>	<b>3685.557</b>	<b>3685.563</b>
6	30.36	27.36	-	25.22	<b>3685.551</b>	<b>3685.558</b>	<b>3685.564</b>
8	40.52	37.52	-	30.30	<b>3685.552</b>	<b>3685.559</b>	<b>3685.566</b>
10	50.68	47.68	40.46	25.22	<b>3685.553</b>	<b>3685.560</b>	<b>3685.567</b>
12	60.84	57.84	50.62	30.30	<b>3685.554</b>	<b>3685.561</b>	<b>3685.568</b>
L1 mm					97.00	230.35	363.70
L2 mm					90.00	223.35	356.70

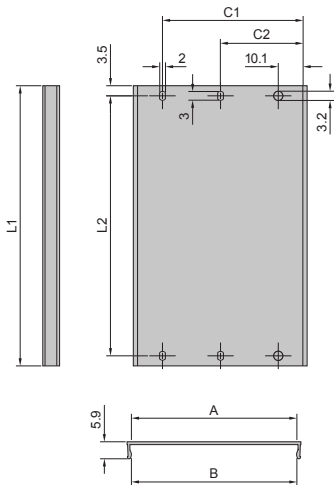

### Type III handle, extractor

**Material:**  
Fibreglass-reinforced polycarbonate  
Base section nickel-plated ABS

**Colour:**  
Grey

HP	Packs of	Model No. RP
3	1	<b>3685.591</b>
4	1	<b>3685.592</b>

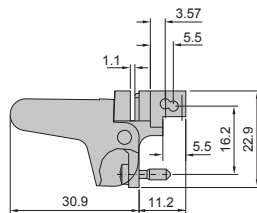
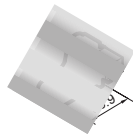

### Covers for panel and spaces

**Material:**  
Fibreglass-reinforced polycarbonate

HP	Width mm	Packs of	Model No. RP
1	5	1	<b>3687.529</b>
2	10.08	1	<b>3687.530</b>
4	20.24	1	<b>3687.531</b>

## Front panels, handles



### Universal holder

for front panel support

**Material:**  
Nickel-plated plastic

HP	Packs of	Model No. RP
4	1	3687.545



### Flat front panels

with type V handle and PCB holder  
Complete modular systems

**Material:**  
Front panel: 2.5 mm Aluminium, natural anodised  
Handle: Aluminium, natural anodised  
PCB holder: Polycarbonate

**Supply includes:**  
1 front panel,  
1 handle (2 with 6 U),  
1 PCB holder (2 with 6 U),  
assembly parts.

HP	a mm	W (B) mm	Model No. RP	
			3U H = 128.7	6U H = 262.05
3	14.9	–	3652.000	3652.200
4	20.0	–	3652.010	3652.210
5	25.1	–	3652.020	3652.220
6	30.1	–	3652.030	3652.230
7	35.2	–	3652.040	3652.240
8	40.3	–	3652.050	3652.250
10	50.5	35.6	3652.060	3652.260
12	60.6	45.7	3652.070	3652.270
14	70.8	55.9	3652.080	–

Available with optional metal screw collars.

**Accessories:**

Identification strips for handles,

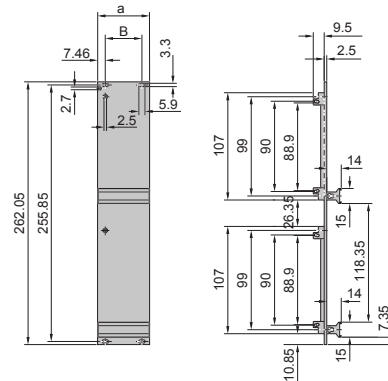
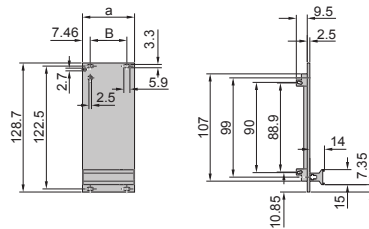
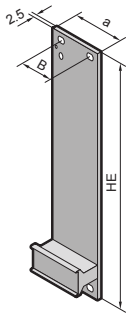

## Front panels, handles

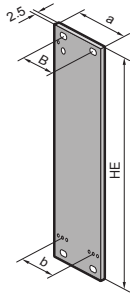

### Flat front panels for type V and VI handle

**Material:**  
2.5 mm Aluminium, anodised

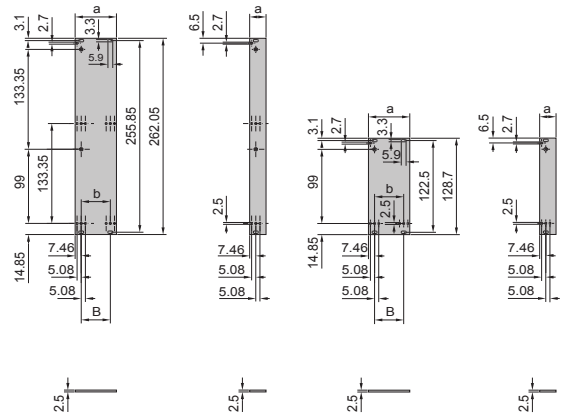

HP	a mm	W (B) mm	b mm	Packs of	Model No. RP	
					3U	6U
3	14.9	-	-	1	3685.569	3685.578
4	20.0	-	-	1	3685.570	3685.579
5	25.1	-	-	1	3685.571	3685.580
6	30.2	-	15.2	1	3685.572	3685.581
7	35.2	-	20.3	1	3685.573	3685.582
8	40.3	-	25.4	1	3685.574	3685.583
10	50.5	35.6	35.6	1	3685.575	3685.584
12	60.6	45.7	45.7	1	3685.576	3685.585
14	70.8	55.9	55.9	1	3685.577	3685.586

Available with optional metal screw collars.

**! Also required:**  
Collar screws and plastic collars, packs of 100 sets, Model No. RP 3658.160,

**+ Accessories:**  
Handles type V  
Handles type VI

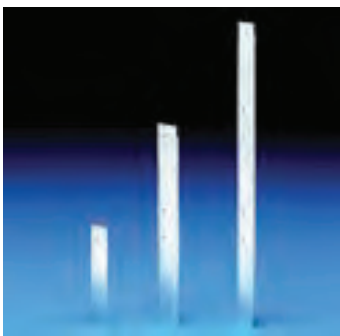

### U-channel front panels for type V and VII handle

**Material:**  
2.5 mm aluminium, clear-chromated

**Supply includes:**  
1 vertical EMC gasket, version 1.



HP	a mm	W (B) mm	Packs of	Model No. RP	
				3U	6U
4	20.0	-	1	3687.655	3687.660
6	30.2	-	1	3687.656	3687.661
8	40.3	-	1	3687.657	3687.662
10	50.5	35.6	1	3687.658	3687.663
12	60.6	45.7	1	3687.659	3687.664

**! Also required:**  
Slotted centering screws, packs of 100, Model No. RP 3687.050  
Posidrive centering screws, packs of 100, Model No. RP 3687.051

**+ Accessories:**  
Handles type V  
Handles type VI

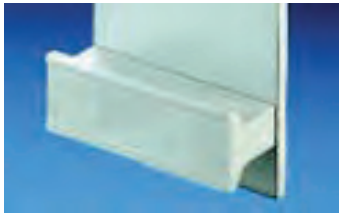
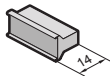

## Front panels, handles

**Type V handle****Plastic****Material:**  
Plastic

HP	Colour	Packs of	Model No. RP
3	Grey	1	3685.490
4	Grey	1	3685.491
8	Grey	1	3685.492
12	Grey	1	3685.493
20	Grey	1	3685.494
3	Black	1	3685.495
4	Black	1	3685.496
8	Black	1	3685.497
12	Black	1	3685.498
20	Black	1	3685.499

**Also required:**Mounting kit,  
packs of 1 set, Model No. RP 3687.519**Identification strips  
for type V handle, plastic  
self-adhesive**

HP	Packs of	Model No. RP
24	1	3687.693

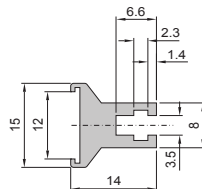
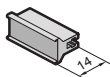
**Type V handle****Aluminium****Material:**  
Aluminium, anodised.

HP	Model No. RP	HP	Model No. RP
3	3685.595	12	3685.602
4	3685.596	14	3685.603
5	3685.597	21	3685.761
6	3685.598	28	3685.762
7	3685.599	42	3685.763
8	3685.600	1 m	3685.604
10	3685.601		



Custom lengths available.

**Also required:**Mounting kit  
packs of 1 set, Model No. RP 3687.146  
(from 6 HP 2 packs required)**Identification strips  
for type V handle, aluminium**

For individual labelling of the handles.

**Material:**  
0.5 mm Aluminium, anodised

HP	Packs of	Model No. RP
3	1	3685.746
4	1	3685.747
5	1	3685.748
6	1	3685.749
7	1	3685.750
8	1	3685.751
10	1	3685.752
12	1	3685.753
14	1	3685.754
21	1	3685.755
28	1	3685.756
42	1	3685.757
1 m	1	3685.758
0.5 m	5	3606.300



Custom lengths available.



## Front panels, handles

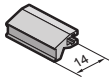
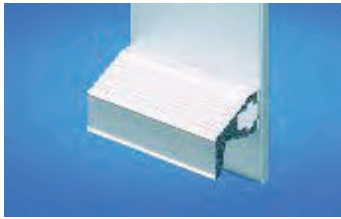

### Type VI handle

**Aluminium**

**Material:**  
Aluminium, anodised

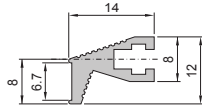

HP	Model No. RP	HP	Model No. RP
3	3685.605	12	<b>3685.612</b>
4	3685.606	14	<b>3685.613</b>
5	3685.607	21	<b>3685.614</b>
6	3685.608	28	<b>3685.615</b>
7	3685.609	42	<b>3685.616</b>
8	3685.610	84	<b>3685.617</b>
10	3685.611	1 m	<b>3685.618</b>

Custom lengths available.



**Also required:**

Mounting kit  
packs of 1 set, Model No. RP 3687.146  
(from 6 HP 2 packs required)



### PCB holder kit

**For attaching the PCB to front panels with handle types I, II, IV, IVs, VII.**

**Material:**  
Die-cast

**Note:**  
Only required at the top with 3U front panels.

Packs of	Model No. RP
10	<b>3685.198</b>



**Also required:**

For securing PCBs to PCB holders:  
Pan-head screws  
packs of 100, Model No. RP 3654.320  
For attaching the front panel to the PCB holder:  
Oval head screw  
packs of 100, Model No. RP 3685.282.



### PCB holder

**For front panels**  
For attaching PCBs to front panels  
(handle type V, VI).

**Material:**  
Noryl

**Supply includes:**  
Assembly parts.

Packs of	Model No. RP
10	<b>3606.330</b>

