

Air baffle

For controlled air flow in 7 U subracks.
For mounting on subrack side panels with the aid of mounting blocks.

Material:
1 mm aluminium

Supply includes:
Assembly parts.

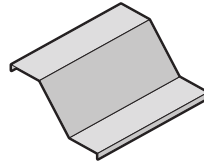
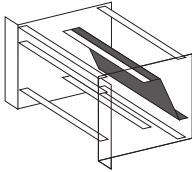

Subrack depth mm	Model No. RP
285	3685.302
345	3685.303
405	3684.320
465	3684.321
525	3684.322

Custom versions available upon request.

! Also required:

Mounting blocks,

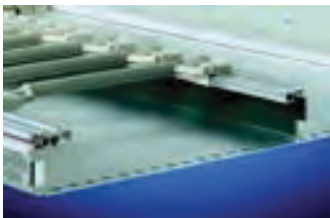

Air partition

For controlled air flow in the subrack. The partitions are mounted on the horizontal rails together with the backplanes.

Material:
Epoxy

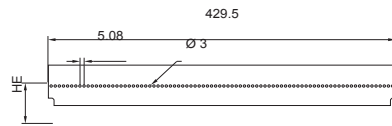
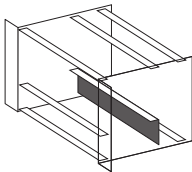

U	Model No. RP
1/2	3684.870
1	3684.871
3	3684.872

Custom versions available upon request.

! Also required:

Fastening screws and washers,
packs of 100, Model No. RP 3684.019,

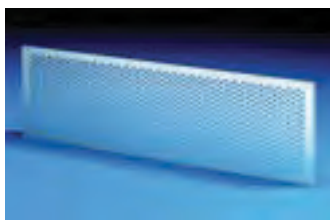

Front/rear panels for ventilation

Material:
2.5 mm aluminium

Surface finish:
Anodised,
clear-chromated (EMC version)

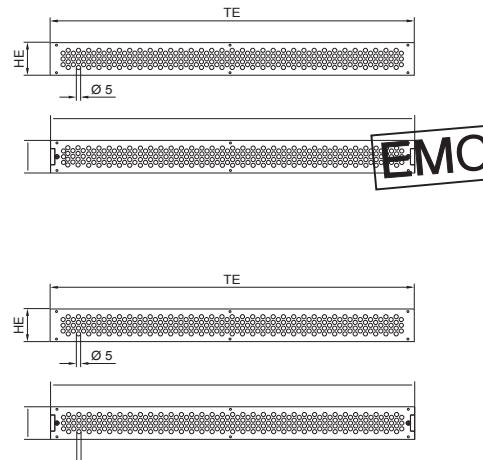
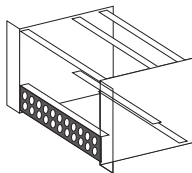

U (HE)	HP (TE)	Packs of	Model No. RP
1	84	1	3684.812
2	84	1	3684.813
3	84	1	3684.814

Custom versions available upon request.

! Also required:

Collar screws (slotted) and plastic collars,
packs of 100 sets, Model No. RP 3658.160,

EMC version:

U (HE)	HP (TE)	Packs of	Model No. RP
1	84	1	3684.281
2	84	1	3684.282
3	84	1	3684.283

Custom versions available upon request.

! Also required:

Centering screws

EMC version supply includes:

- 1 front panel,
- 1 contact strip,
- 1 gasket strip,
- 1 vertical EMC gasket, assembly parts.

Front/rear panels for ventilation
EMC Front/rear panels for ventilation



Rear panels for fan installation

Material:
2.5 mm aluminium

Surface finish:
Anodised,
clear-chromated (EMC version)

EMC version supply includes:
1 rear panel,
1 contact strip,
1 gasket strip,
1 vertical EMC gasket,
assembly parts.

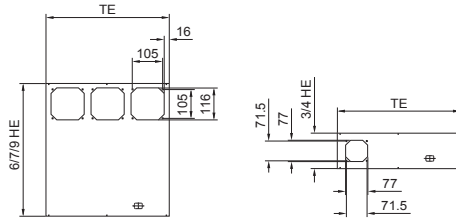
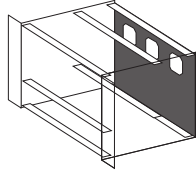

Rear panels:for fan installation
EMC:Rear panels for fan installation
Rear panels:horizontally hinged for fan installation

U (HE)	HP (TE)	For fans mm	Packs of	Model No. RP
3	85	80	1	3684.839
4	85	80	1	3684.840
6	85	120	1	3684.841
7	85	120	1	3684.842

Custom versions available upon request.

! Also required:

Collar screws (slotted) and plastic collars, packs of 100 sets, Model No. RP 3658.160,

EMC version:

U (HE)	HP (TE)	For fans mm	Packs of	Model No. RP
3	84	80	1	3684.284
4	84	80	1	3684.285
6	84	120	1	3684.286
7	84	120	1	3684.287

Custom versions available upon request.

! Also required:

Centering screws,

+ Accessories:

Fans,



Rear panels, horizontally hinged for fan installation

Material:
2.5 mm aluminium

Surface finish:
Anodised,
clear-chromated (EMC version)

Supply includes:
1 rear panel,
1 set of hinges,
assembly parts.

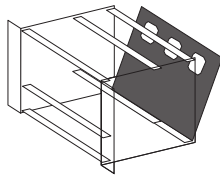

EMC version supply includes:
1 rear panel,
1 contact strip,
1 gasket strip,
1 vertical EMC gasket,
1 set of hinges,
assembly parts.

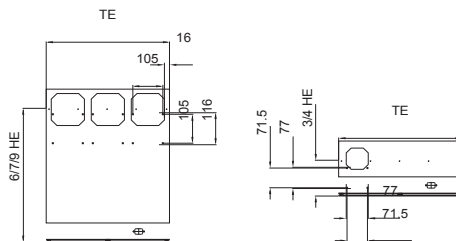

U (HE)	HP (TE)	For fans mm	Packs of	Model No. RP
3	85	80	1	3684.304
4	85	80	1	3684.305
6	85	120	1	3684.306
7	85	120	1	3684.307

Custom versions available upon request.

! Also required:

Collar screws (slotted) and plastic collars, packs of 100 sets, Model No. RP 3658.160,

EMC version:

U (HE)	HP (TE)	For fans mm	Packs of	Model No. RP
3	84	80	1	3684.311
4	84	80	1	3684.312
6	84	120	1	3684.313
7	84	120	1	3684.314

Custom versions available upon request.

! Also required:

Centering screws,

+ Accessories:

Fans,