

Front Horizontal Rail (A)



For accommodation of guide rails and securing of front panels.

- HP pitch pattern of holes for exact mounting of guide rails
- M 4 thread at ends
- Straight-through core hole
- Horizontal rail 192HP for cutting to length

Material:
Extruded aluminum

Surface Finish:
Clear chromated
²Flash anodized

Note: Order assembly screws separately.

	Packs of	Order No.
M4 x 12	100	3654300

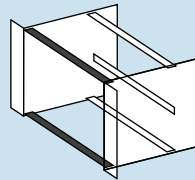
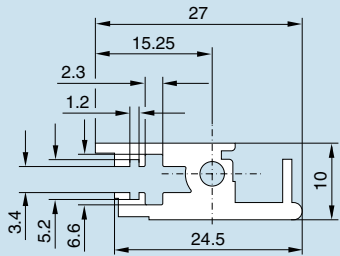

Usable width (HP)	Packs of	Order No.
4 (left)	1	3684592
4 (right)	1	3684955
8 (left)	1	3684593
8 (right)	1	3684956
12	1	3684594
16	1	3684595
20	1	3684596
21	1	3685985
40	1	3684960
42	1	3684560
63	1	3684561
84	1	3684562
84	2	3685267 ¹⁾
192	1	3688000 ²⁾

¹⁾ Including 4 assembly screws

EMC gaskets, see page 177

Front Horizontal Rail (B) With 10 mm Extension For Type IV And VII Injector/Extractor Handle



For accommodation of guide rails and securing of front panels.

- Front projection and hole pattern based on IEEE 1101.10 when using type IV and VII injectors/extractors
- HP pitch pattern of holes for exact mounting of guide rails
- M 4 thread at ends
- Straight-through core hole
- Horizontal rail 192HP for cutting to length

Usable width (HP)	Packs of	Order No.
40	1	3684961
42	1	3684565
63	1	3684566
84	1	3684567
84	2	3685269 ¹⁾
192	1	3688001 ²⁾

¹⁾ Including 4 assembly screws

Note: Order assembly screws separately.

	Packs of	Order No.
M4 x 12	100	3654300

Material:
Extruded aluminum

Surface Finish:
Clear chromated
²Flash anodized

EMC gaskets, see page 177

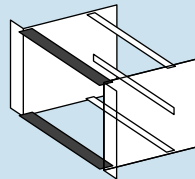
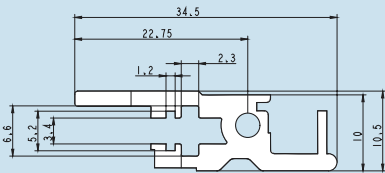

Individual Subrack Components

Horizontal Rails

Ripac Extrusion System: Complete, Simple And Well-Organized

Main extrusions	A Front horizontal rail	B Front horizontal rail with 10mm extension for extractor handle type IV or VII	B1 Double front horizontal rail with 10 mm extension	C1 Rear horizontal rail	C3 Rear horizontal rail with integral Z rail	C4 Rear horizontal rail for Ripac ECO	C5 Rear horizontal rail with integral Z rail for Ripac ECO	D1 Rear horizontal rail, center	D2 Rear horizontal rail, center, with integral Z rail
Additional extrusions									
E Rear adapter rail, center, to accommodate plastic guide rails 	-	-	-	-	-	-	-		
F Z rail for connectors 	-	-	-		-		-		-
G Insulating strip* 	-	-	-		-		-		-
H Conductive strip* 	-	-	-		-		-		-
I Threaded insert 				-				-	
J Identification strip 							-	-	-
K EMC gasket, horizontal 				-	-		-	-	-

* For conductive or insulated attachment of backplanes

All system requirements are covered by just a few basic horizontal rail types. This is a well-organized, cost-effective range to fit all subrack systems and the instrument case/rackmounted enclosure range Ripac Vario-Module.

